

FOR LEASE / FOR SALE | INDUSTRIAL PROPERTY

206 - 208 WEST HI LINE ROAD

PHARR, TX 78577



FORUM
CRE



PROPERTY SPECIFICATIONS

Building Size:	30,460 SF
Available SF:	15,000 SF
Office Space:	1 Private Office & Restroom
Lot Size:	3.4 Acres
Clear Height:	18' - 20'
Dock Doors:	2
Dimensions:	157' x 194'
Fire Protection:	Sprinklered
Lighting:	Fluorescent in Warehouse
Auto Parks:	46

PROPERTY OVERVIEW

206-208 W Hi Line Road is an industrial warehouse on 3.4 AC. This property totals 30,460 SF of building, of which 15,632 SF is available with 2,500 SF of office/showroom. The building has an 18'-20' clear height and offers 1 grade-level door. The property is located in Pharr, TX, and is 1.8 miles from the Pharr International Bridge, 5.6 miles to Interstate 2 and Interstate I69C, and 12.2 miles from the Anzalduas International Bridge.

PROPERTY HIGHLIGHTS

- LAND EXPANSION AVAILABLE
- CLOSE PROXIMITY TO PHARR INTERNATIONAL BRIDGE

JABONEY RODRIGUEZ, CCIM

jaboneyr@forumcre.com

M: 956.720.7523

O: 956.322.4799 X152

FOR LEASE / FOR SALE | INDUSTRIAL PROPERTY

206 - 208 WEST HI LINE ROAD

PHARR, TX 78577



FORUM
CRE

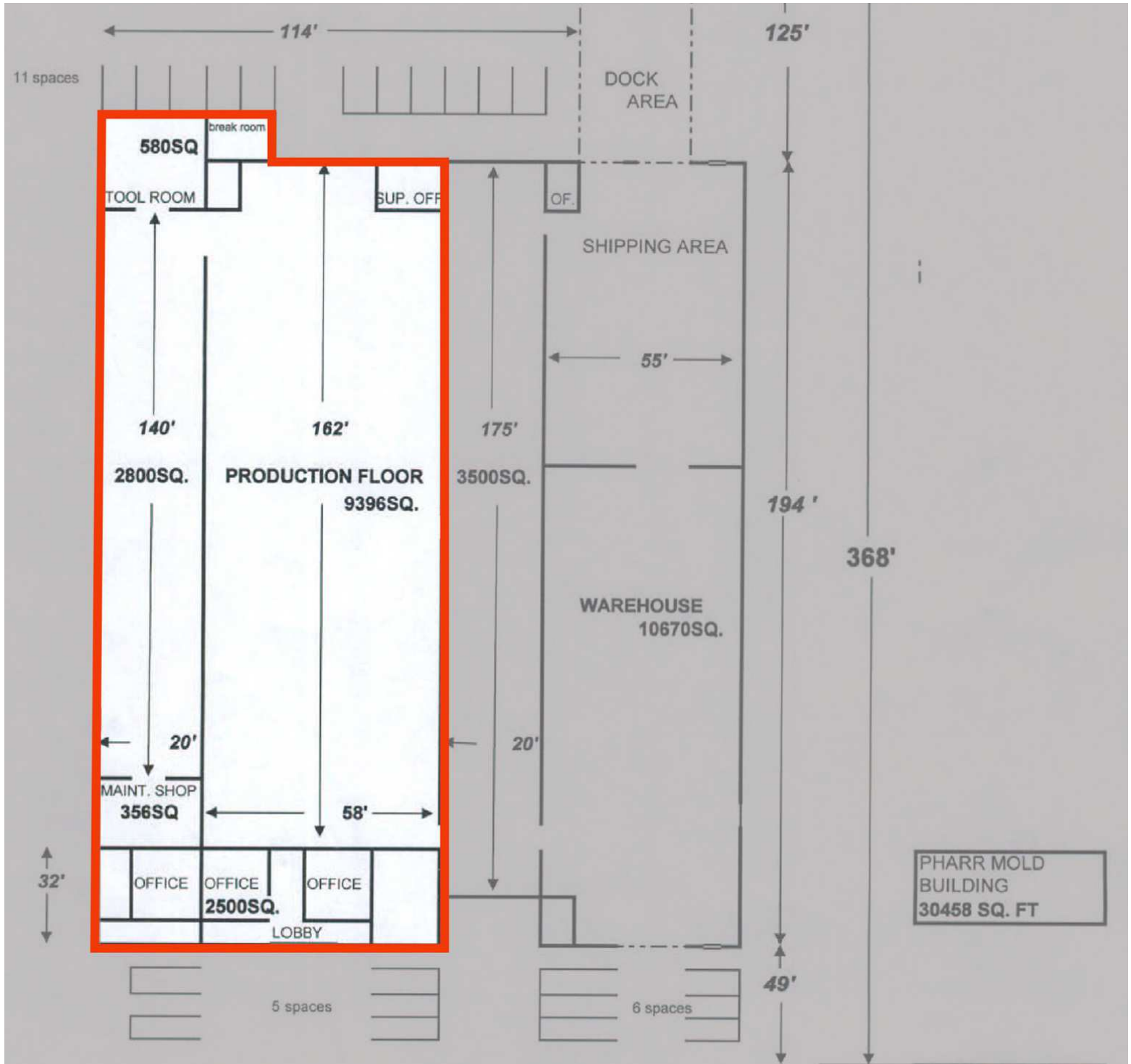

JABONEY RODRIGUEZ, CCIM

jaboneyr@forumcre.com

M: 956.720.7523

O: 956.322.4799 X152

FOR LEASE | INDUSTRIAL PROPERTY

206- 208 WEST HI LINE ROAD

PHARR, TX 78577



FORUM
CRE



JABONEY RODRIGUEZ, CCIM

jaboneyr@forumcre.com

M: 956.720.7523

O: 956.322.4799 X152



Information About Brokerage Services

Texas law requires all real estate licensees to give the following information about brokerage services to prospective buyers, tenants, sellers and landlords.

TYPES OF REAL ESTATE LICENSE HOLDERS:

- # **A BROKER** is responsible for all brokerage activities, including acts performed by sales agents sponsored by the broker.
- # **A SALES AGENT** must be sponsored by a broker and works with clients on behalf of the broker.

A BROKER'S MINIMUM DUTIES REQUIRED BY LAW (A client is the person or party that the broker represents):

- # Put the interests of the client above all others, including the broker's own interests;
- # Inform the client of any material information about the property or transaction received by the broker;
- # Answer the client's questions and present any offer to or counter-offer from the client; and
- # Treat all parties to a real estate transaction honestly and fairly.

A LICENSE HOLDER CAN REPRESENT A PARTY IN A REAL ESTATE TRANSACTION:

AS AGENT FOR OWNER (SELLER/LANDLORD): The broker becomes the property owner's agent through an agreement with the owner, usually in a written listing to sell or property management agreement. An owner's agent must perform the broker's minimum duties above and must inform the owner of any material information about the property or transaction known by the agent, including information disclosed to the agent or subagent by the buyer or buyer's agent.

AS AGENT FOR BUYER/TENANT: The broker becomes the buyer/tenant's agent by agreeing to represent the buyer, usually through a written representation agreement. A buyer's agent must perform the broker's minimum duties above and must inform the buyer of any material information about the property or transaction known by the agent, including information disclosed to the agent by the seller or seller's agent.

AS AGENT FOR BOTH - INTERMEDIARY: To act as an intermediary between the parties the broker must first obtain the written agreement of each party to the transaction. The written agreement must state who will pay the broker and, in conspicuous bold or underlined print, set forth the broker's obligations as an intermediary. A broker who acts as an intermediary:

- # Must treat all parties to the transaction impartially and fairly;
- # May, with the parties' written consent, appoint a different license holder associated with the broker to each party (owner and buyer) to communicate with, provide opinions and advice to, and carry out the instructions of each party to the transaction.
- # Must not, unless specifically authorized in writing to do so by the party, disclose:
 - o that the owner will accept a price less than the written asking price;
 - o that the buyer/tenant will pay a price greater than the price submitted in a written offer; and
 - o any confidential information or any other information that a party specifically instructs the broker in writing not to disclose, unless required to do so by law.

AS SUBAGENT: A license holder acts as a subagent when aiding a buyer in a transaction without an agreement to represent the buyer. A subagent can assist the buyer but does not represent the buyer and must place the interests of the owner first.

TO AVOID DISPUTES, ALL AGREEMENTS BETWEEN YOU AND A BROKER SHOULD BE IN WRITING AND CLEARLY ESTABLISH:

- # The broker's duties and responsibilities to you, and your obligations under the representation agreement.
- # Who will pay the broker for services provided to you, when payment will be made and how the payment will be calculated.

LICENSE HOLDER CONTACT INFORMATION: This notice is being provided for information purposes. It does not create an obligation for you to use the broker's services. Please acknowledge receipt of this notice below and retain a copy for your records.

FORUM CRE, LLC.	9002545	carlom@forumcre.com	(956)717-9090
Licensed Broker /Broker Firm Name or Primary Assumed Business Name	License No.	Email	Phone
Carlo A. Molano	565621	carlom@forumcre.com	(956)523-9403
Designated Broker of Firm	License No.	Email	Phone
Carlo A. Molano	565621	carlom@forumcre.com	(956)523-9403
Licensed Supervisor of Sales Agent/ Associate	License No.	Email	Phone
Jaboney R. Rodriguez	665475	jaboneyr@forumcre.com	(956)720-7523
Sales Agent/Associate's Name	License No.	Email	Phone

Buyer/Tenant/Seller/Landlord Initials

Date

Regulated by the Texas Real Estate Commission

TXR-2501

FORUM CRE, 10410 Medical Loop 5A Laredo TX 78045
Miguel Rodriguez

Information available at www.trec.texas.gov

IABS 1-0 Date

Phone: 9562861926

Fax:

801 Union Pacific

Produced with Lone Wolf Transactions (zipForm Edition) 231 Shearson Cr. Cambridge, Ontario, Canada N1T 1J5 www.lwof.com